

FACADE

LDSOSP5.2/10.4FA

TRANSPARENT LED CURTAIN FOR
ARCHITECTURAL FACADE APPLICATIONS

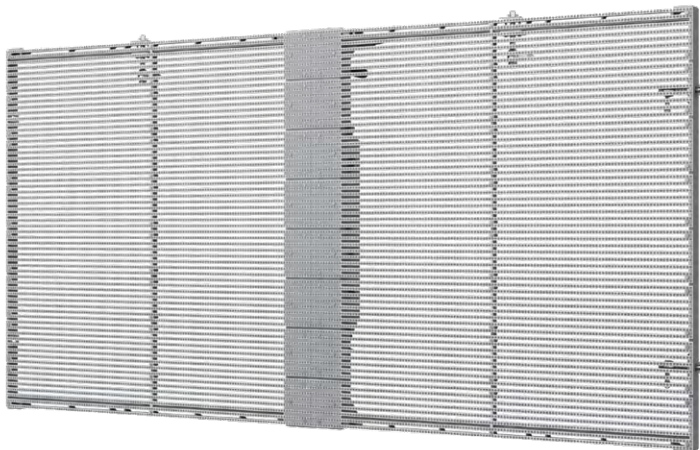

- Right choice for facades with front or rear access
- Intelligent construction for ultra-thin frame depth
- Lightweight for easy adaptation and low cost framework design
- The right solution for architectural and facade installations
- Improved mask structure that increases viewing angle

PASABAHCE STORE
ISTANBUL / TURKEY



General

Operating environment	outdoor
Pixel pitch	5.2(H)/10.41mm(V)
Service type	front and rear access
Calibrated brightness (nits)	4500nits
Lamp type	SMD
Lifespan (hours at %50 brightness)	>100.000hours
White color calibration (adj.)	3.500K~8.500K
Gray scale	>16bits
Brightness control	256 level

Module Specifications

Module dimensions (mm)	500x250
Refresh frequency	1.920Hz
Module resolution	96x24px
LED drive method	dynamic
Module material	aluminum
Module type	sealed
PCB type	multilayer
PCB surface coating	humiseal

Panel Specifications

Panel material	Die-cast aluminum
Panel paint	ES powder coated
Panel dimensions 'mm'	1.000x500
IP level	IP54 front and rear
Transparency ratio	60%
Panel weight	<20kg
Panel resolution	192x48px
Pixel density (pcs/sqm)	18.432
Viewing angle (horizontal x vertical)	>120° x 120°
Minimum viewing distance	>7m
Operating temperature range	-5°C ~ +50°C
Storage temperature range	-20°C ~ +60°C
Operating humidity	10% ~ 90% non-condensing
Power input voltage	110 ~ 240 VAC
Power input frequency	50 ~ 60 Hz
Average power per sqm	<100W
Max power per sqm	<600W
Active PFC	YES
Load tolerance ²	25% min.
Panel installation type	Rental type
Cooling	Passive cooling

Other

Max input resolution	FHD, UHD, 4K, 8K
Standard video sources ³	All digital formats
Brightness adjustment	Automatic & manual
Death pixel monitoring	Optional
Module monitoring	YES
Temperature monitoring	YES
Smoke monitoring	Optional
Voltage monitoring	YES
Power redundancy	N/A
Signal path backup	YES
Signal transmission	CAT or Fiber Optic
Standby scheduling	YES
Power on/off scheduling	Optional
Power saving mode	YES
Certification	CE-EMC, CE-LVD, RoHS, FCC

Options

*The mechanical and electronic specification options are available.

- 1- Panel dimensions can change upon customer request
- 2- That value is the remain capacity of PSU's at 100% brightness and white color content
- 3- Different types of video input available as option

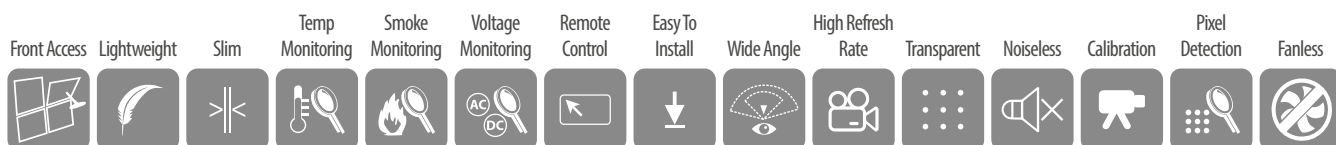

Apron Teknoloji AS. reserves the right to change any product specification, discontinue of any product or services without prior notice
The icons above indicate optional features

TECHNICAL SPECIFICATIONS

LEDECA