

# FACADE

# LDSISP02.8/5.6FA

TRANSPARENT LED CURTAIN FOR ARCHITECTURAL FACADE APPLICATIONS

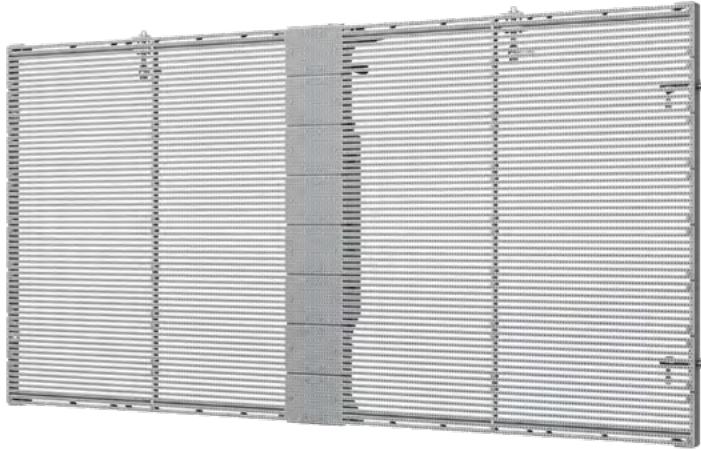

- Right choice for facades with front or rear access
- Intelligent construction for ultra-thin frame depth
- Lightweight for easy adaptation and low cost framework design
- The right solution for architectural and facade installations
- Improved mask structure that increases viewing angle

**PASABAHCE STORE**  
ISTANBUL / TURKEY



TECHNICAL SPECIFICATIONS

### General

Operating environment	indoor and semi outdoor
Pixel pitch	2.6(H)/5.2mm(V)
Service type	front and rear access
Calibrated brightness (nits)	4,000nits
Lamp type	SMD
Lifespan (hours at %50 brightness)	>100,000hours
White color calibration (adj.)	3,500K~8,500K
Gray scale	>16bits
Brightness control	256 level

### Module Specifications

Module dimensions (mm)	500x125
Refresh frequency	1,920Hz
Module resolution	178x22px
LED drive method	dynamic
Module material	aluminum
Module type	sealed
PCB type	multilayer
PCB surface coating	humiseal

### Panel Specifications

Panel material	Die-cast aluminum
Panel paint	ES powder coated
Panel dimensions 'mm'	1,000x500
IP level	IP54 front and rear
Transparency ratio	55%
Panel weight	<20kg
Panel resolution	356x88px
Pixel density (pcs/sqm)	62,656
Viewing angle (horizontal x vertical)	>120° x 120°
Minimum viewing distance	>4m
Operating temperature range	-5°C ~ +50°C
Storage temperature range	-20°C ~ +60°C
Operating humidity	10% ~ 90% non-condensing
Power input voltage	110 ~ 240 VAC
Power input frequency	50 ~ 60 Hz
Average power per sqm	<100W
Max power per sqm	<600W
Active PFC	YES
Load tolerance <sup>2</sup>	25% min.
Panel installation type	Fixed installation
Cooling	Passive cooling

### Other

Max input resolution	FHD, UHD, 4K, 8K
Standard video sources <sup>3</sup>	All digital formats
Brightness adjustment	Automatic & manual
Death pixel monitoring	Optional
Module monitoring	YES
Temperature monitoring	YES
Smoke monitoring	Optional
Voltage monitoring	YES
Power redundancy	N/A
Signal path backup	YES
Signal transmission	CAT or Fiber Optic
Standby scheduling	YES
Power on/off scheduling	Optional
Power saving mode	YES
Certification	CE-EMC, CE-LVD, RoHS, FCC

### Options

\*The mechanical and electronic specification options are available.

- 1- Panel dimensions can change upon customer request
- 2- That value is the remain capacity of PSU's at 100% brightness and white color content
- 3- Different types of video input available as option

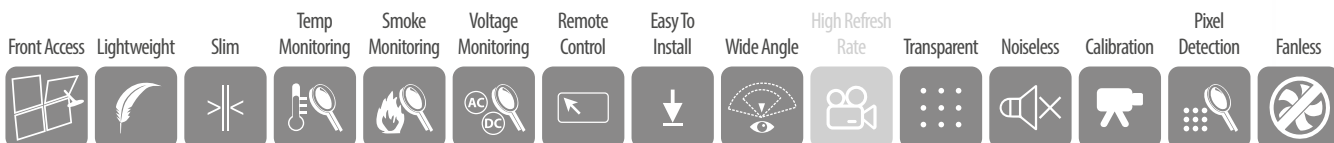

Apron Teknoloji AS. reserves the right to change any product specification, discontinue of any product or services without prior notice

LEDECA