

# CITYLINE LDCOSP05.0CL

OUTDOOR LED SCREENS FOR DIGITAL  
OUT-OF-HOME MESSAGING



- New generation cost effective led screen panel for outdoor use
- Right choice for DOOH media screen installations
- Lightweight for easy adaptation and low cost framework design
- Production level calibration for best color uniformity

**KADIKOY PIER BOOK CAFE**  
ISTANBUL / TURKEY



## General

Operating environment	outdoor
Pixel pitch	5mm
Service type	rear access
Calibrated brightness (nits)	6.000nits
Lamp type	SMD
Lifespan (hours at %50 brightness)	>100.000hours
White color calibration (adj.)	3.500K~8.500K
Gray scale	>16bits
Brightness control	256 level

## Module Specifications

Module dimensions (mm)	320x160
Refresh frequency	adjustable
Module resolution	64x32px
LED drive method	dynamic
Module material	plastic (PC)
Module type	apparent
PCB type	multilayer
PCB surface coating	humiseal

## Panel Specifications

Panel material	galvanized steel sheet/aluminum
Panel paint	ES powder coated
Panel dimensions (mm) <sup>1</sup>	960x960
IP level	IP67 front, IP54 rear
Panel weight	45kg/35kg
Panel resolution	192x192px
Pixel density (pcs/sqm)	40.000
Viewing angle (horizontal x vertical)	>120°x120°
Minimum viewing distance	>5m
Operating temperature range	-15°C ~ +45°C
Storage temperature range	-40°C ~ +60°C
Operating humidity	10% ~ 90% non-condensing
Power input voltage	110~240 VAC
Power input frequency	50~60 Hz
Average power per sqm	<150W
Max power per sqm	<650W
Active PFC	YES
Load tolerance <sup>2</sup>	25% min.
Panel installation type	Fixed installation
Cooling	Internal fan

## Other

Max input resolution	FHD, UHD, 4K, 8K
Standard video sources <sup>3</sup>	All digital formats
Brightness adjustment	Automatic & manual
Death pixel monitoring	Optional
Module monitoring	YES
Temperature monitoring	YES
Smoke monitoring	Optional
Voltage monitoring	YES
Power redundancy	N/A
Signal path backup	YES
Signal transmission	CAT or Fiber Optic
Standby scheduling	YES
Power on/off scheduling	Optional
Power saving mode	YES
Certification	CE-EMC, CE-LVD, RoHS, FCC

## Options

\*The mechanical and electronic specification options are available.

- 1- Panel dimensions can change upon customer request
- 2- That value is the remain capacity of PSU's at 100% brightness and white color content
- 3- Different types of video input available as option

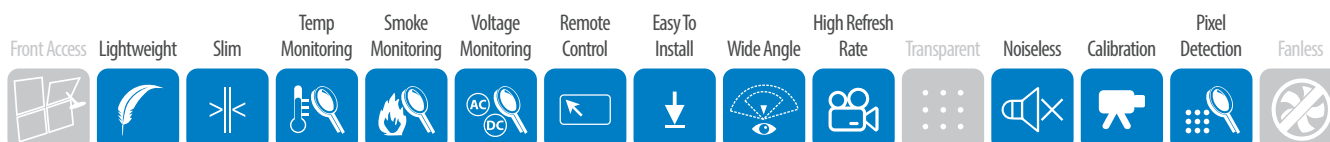

Apron Teknoloji AS. reserves the right to change any product specification, discontinue of any product or services without prior notice